

ECW-281B/B2 Series

Fanless Embedded System for Intel® Atom™ Dual core D525/N270

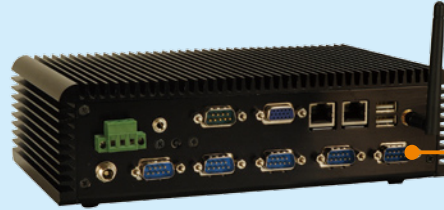

Extended Temperature



6 COM

COM2 for ECW-281B Series

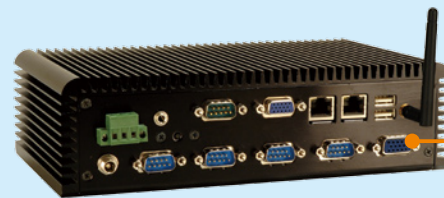

Dual VGA

2nd VGA for ECW-281B2 Series

Features

- ◆ Fanless system with
 - » 1.8 GHz Intel® Atom™ D525 dual-core CPU
 - » 1.6 GHz Intel® Atom™ N270 CPU
- ◆ Supports four USB 2.0 ports and six COM ports
- ◆ Dual GbE LAN ideal for high speed network applications
- ◆ Supports CompactFlash®, 2.5" SATA HDD and SSD storage devices
- ◆ 12 VDC and 9 VDC - 36 VDC power input models available
- ◆ Supports dual VGA display (B2 model only)



Specifications



Model Name	ECW-281B-D525 (ECW-281B2-D525)	ECW-281B-N270 (ECW-281B2-N270)	ECW-281B-N270-WT
Platform	Intel®		
Color	Black		
Dimensions	229 x 132 x 64mm		
Chassis Construction	Aluminum alloy with heavy duty metal		
Motherboard Model	WAFER-PV-D5252	WAFER-945GSE-N270	WAFER-945GSE-N270W2
Processor CPU	Intel® Atom™ D525 Processor 1.8GHz / 1MB L2 cache	Intel® Atom™ N270 1.6GHz / 512KB L2 cache	
Chipset	ICH8M	Intel® 945GSE + ICH7M	Intel® 945GSE + ICH7M
System Memory	1 x 204-pin 1GB DDR3 SODIMM (2GB for optional)	1 x 200-pin 1GB DDR2 SODIMM (2GB for optional)	1 x 200-pin 1GB DDR2 SODIMM (2GB for optional)
Hard Drive	1 x 2.5" SATA HDD space		
Compact Flash	1	1	1
USB 2.0	4	4	4
Ethernet	2 x Realtek RTL8111E PCIe GbE	2 x Realtek RTL8111CP PCIe GbE	2 x Realtek RTL8111CP PCIe GbE
RS-232	6 RS-232 ports for ECW-281B-D525 (COM2: Default RS-232, RS422/485 optional) 5 RS-232 ports for ECW-281B2-D525	6 RS-232 ports for ECW-281B-N270 (COM2: Default RS-232, RS422/485 optional) 5 RS-232 ports for ECW-281B2-N270	6 RS-232 ports for ECW-281B-N270 (COM2: Default RS-232, RS422/485 optional) 5 RS-232 ports for ECW-281B2-N270
Display	1 (2) x VGA	1 (2) x VGA	1 x VGA
Resolution	2048 x 1536 @ 60Hz	1920 x 1200 @ 60Hz	1920 x 1200 @ 60Hz
Audio	1 x speaker out		
Wireless	1 x 802.11 b/g/n	1 x 802.11 b/g/n	N/A
Expansions	1 x PCIe Mini Card slot (reserved for wifi)	1 x PCIe Mini Card slot (reserved for wifi)	1 x PCIe Mini Card slot
Power Consumption	12V@1.79A (Intel® Atom™ D525 1.8GHz with DDR3 1GB)	12V@1.25A (Intel® Atom™ N270 1.6G with 1GB DDR2)	12V@1.25A (Intel® Atom™ N270 1.6G with 1GB DDR2)
Power input	12VDC in 9-36V (WD Model)	12VDC in 9-36V (WD Model)	12VDC in
Mounting	DIN mount, VESA 75 mount, wall mount		
Operating Temperature	-20°C ~ 65°C with CF/SSD -10°C ~ 50°C with HDD	-10°C ~ 60°C with CF/SSD -10°C ~ 50°C with HDD	-20°C ~ 70°C with CF/SSD
Operating Shock	Half sine wave 3G; 11ms 3axis		
Operating Vibration	* MIL-STD-810F 514.5C-1 MIL-STD-810F 514.5C-2	MIL-STD-810F 514.5C-2	MIL-STD-810F 514.5C-2
Weight (Net/Gross)	2.1kg/3.9kg		

*The system that with Hard drive can meet the Standard testing MIL-STD-810F 514.5C-1. and with SSD/CF can meet MIL-STD-810F 514.5C-2

Storage & Expansions

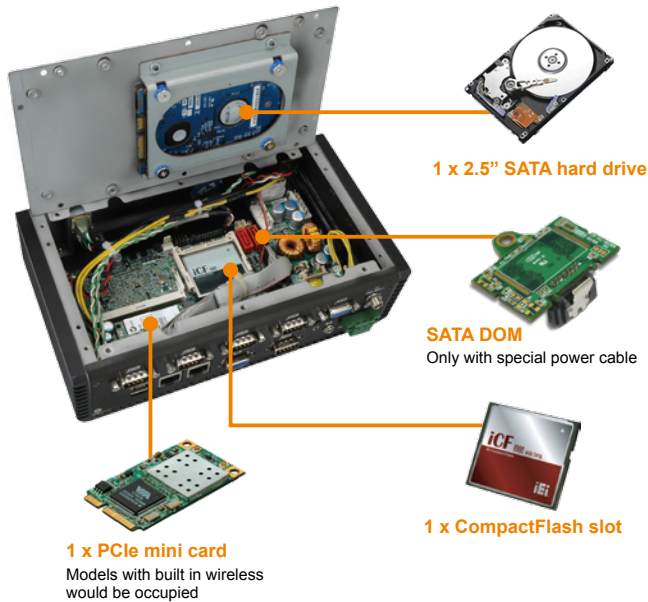

Dual Display

The models of the ECW-281B series, either with Intel® Atom™ N270 single-core processor or D525 dual-core processor, all support dual VGA display through the optional LVDS to VGA converter module. The first VGA output signal is from on-board chipset and supports resolutions up to 2048x1536 (D525) while the second display output is made through the LVDS to VGA converter board (LVDS-VGA-R10) via the LVDS interface and supports resolutions up to 1024x768.

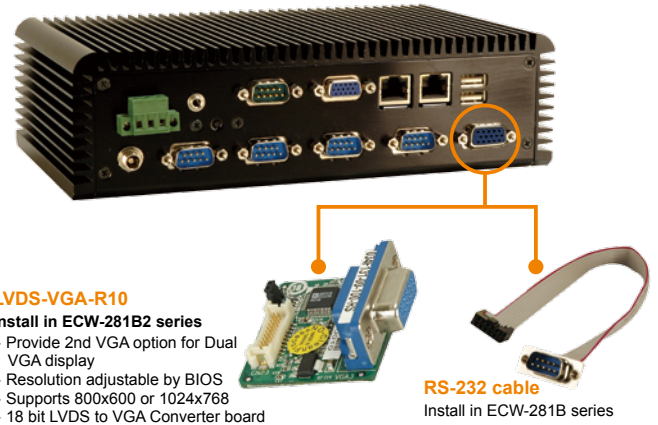

Extended Voltage Input

The ECW-281B rear panel has two types of power input connectors which support either single 12 V DC input or 9~36 V DC input depending on the power module installed in the system.

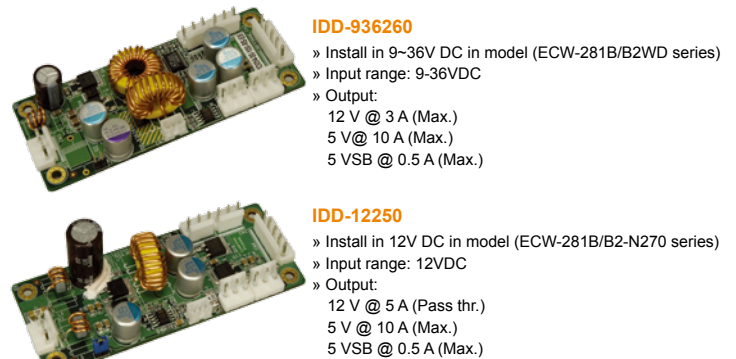
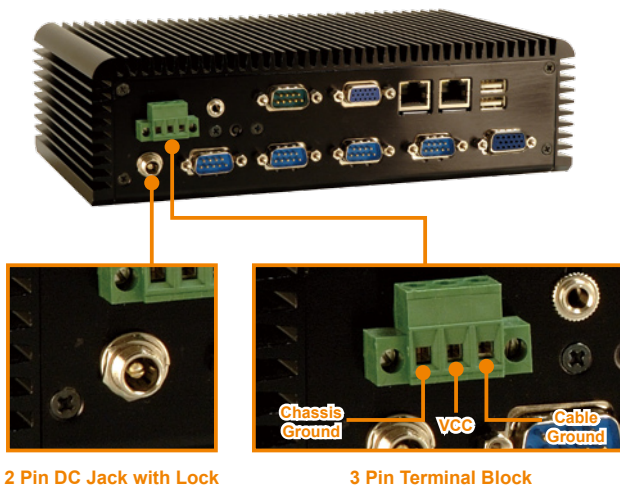

Dimensions (Unit: mm)

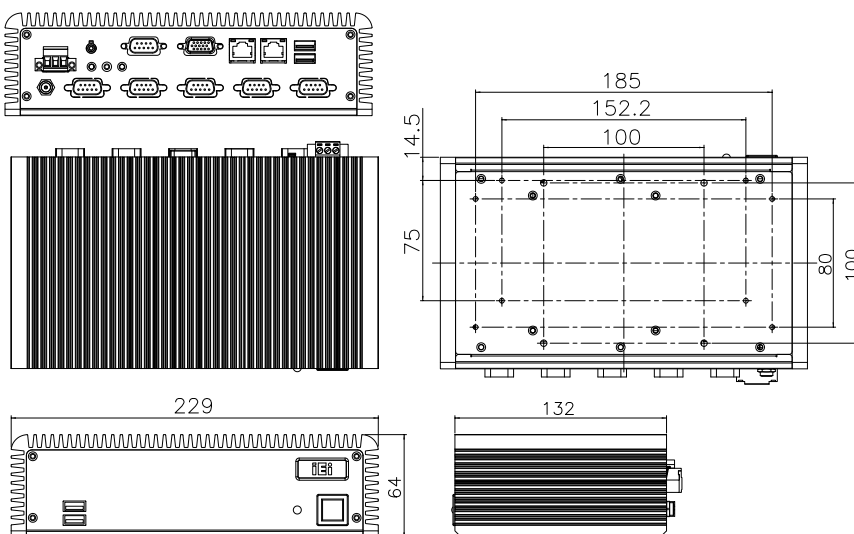

Packing List

1 x QIG
1 x Screw set
1 x DIN mount
1 x Hard drive thermal pad
2 x Wall mount bracket
1 x Driver & user manual CD
1 x 12V 60W power adapter (optional for WD model) (P/N: P/N:63000-FSP060DBAB1552-RS))
1 x Power cord (optional for WD model)
1 x Wireless antenna (for wireless model)



DK-84MB